



NICTD West Lake Corridor Project Construction Update

Week of 5.1.2023 & 5.8.2023

Hammond

- **Closures**
 - Russel Street (between Hohman Avenue and Lyman Avenue)
 - Closure is currently active.
 - See Attached Detour.
 - 165th Street
 - Traffic has been detoured to North half of 165th with one lane in East/West direction.
 - ⑩ Please see attached lane closure details.
 - Waltham Street
 - Closure from May 8th to 12th
 - See attached detour.
- **Utility Relocation, Sewer & Water**
 - Drainage Removals/Installation
 - Future Hammond Gateway Station
 - ⑩ No impact to vehicular traffic
- **Retaining Wall Between Fayette and Douglas Street**
 - Receiving Modular Concrete Blocks
 - Trucking Operations through City of Hammond roadways, minimal impact to vehicular traffic.
 - Framing for concrete.
 - Setting and Backfilling Concrete Blocks
- **Retaining Wall at Blaine between 165th Street and Kenwood Street**
 - Guardrail installation in coming weeks.
- **Monon Trail Closure**
 - Monon closed from Douglas Street to Little Calumet River.
 - Closed indefinitely until rail operation has been complete.
 - No connection to Lackawanna Trail.
- **Rail Construction**
 - Contractor to begin setting rail from South of Douglas Street to Highland Street over the next three.
 - Weekly intersections closures starting at Waltham Street moving South. More information will be distributed as closures are approved.

- Hanover Street will be permanently closed between Wabash and Sheffield Avenues.
- Dearborn at Gostlin Street will be closed permanently.
- **Substructure Work for Bridges, Elevated Structures, and Retaining Walls**
 - Parkway near Michigan Avenue and Hohman Avenue
 - Steel Erection for Bridge Structures over Sibley Street

Munster

- Closures
 - Fisher Street
 - Closure from March 27th – May 3rd.
 - See attached detour.
- NIPSCO & Telecommunications Relocations.
- Retaining Wall between Little Calumet River and Broadmoor
 - Retaining Wall excavation/framing/pouring continues along Manor Ave. North and South of Broadmoor.
 - Trucking operations through the Town of Munster, minimal impact to vehicular traffic.
- Briar Lane
 - Drainage installation near Monon Trail beginning on 5/1/2023 – 5/15/2023
 - Residents near work zone have been notified.
- Monon Trail will be closed for the foreseeable future from Little Calumet River to Fisher Street
 - Closure will last until rail operation is complete from Fisher-Ridge.
 - Closure will last until retaining walls are complete from Ridge to Little Calumet.
 - Noise Wall construction on Monon Trail, between Fisher and Ridge, to begin on 5/3/2023.
- Ongoing underground utility installation through mid-April.
- Structure work at the Little Calumet River.
 - Trucking operations on Manor Avenue, minimal impact to vehicular traffic.
- Station Work
 - Munster-Ridge station
- **Utility Relocation: Storm, Sanitary & Water**
 - Drainage Installation near retaining wall between Broadmoor and Little Calumet River.
 - Drainage Installation between Fisher Street and Ridge Road along Monon Trail
 - No impact to vehicular traffic
 - Drainage Installation near CSX track and Superior Avenue.
 - No impact to vehicular traffic

Dyer

- No active work at this time.

For additional project information please visit: www.nictdwestlake.com or www.fhp-rb.com

PLOT DATE: 8/18/2022 PLOT TIME: 12:39:30 PM
 FILE NAME: SHT-M-CI01-MTBA-03.dgn

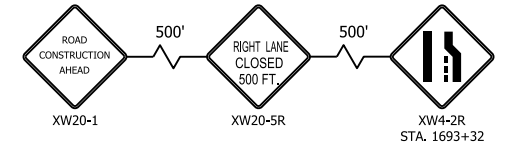
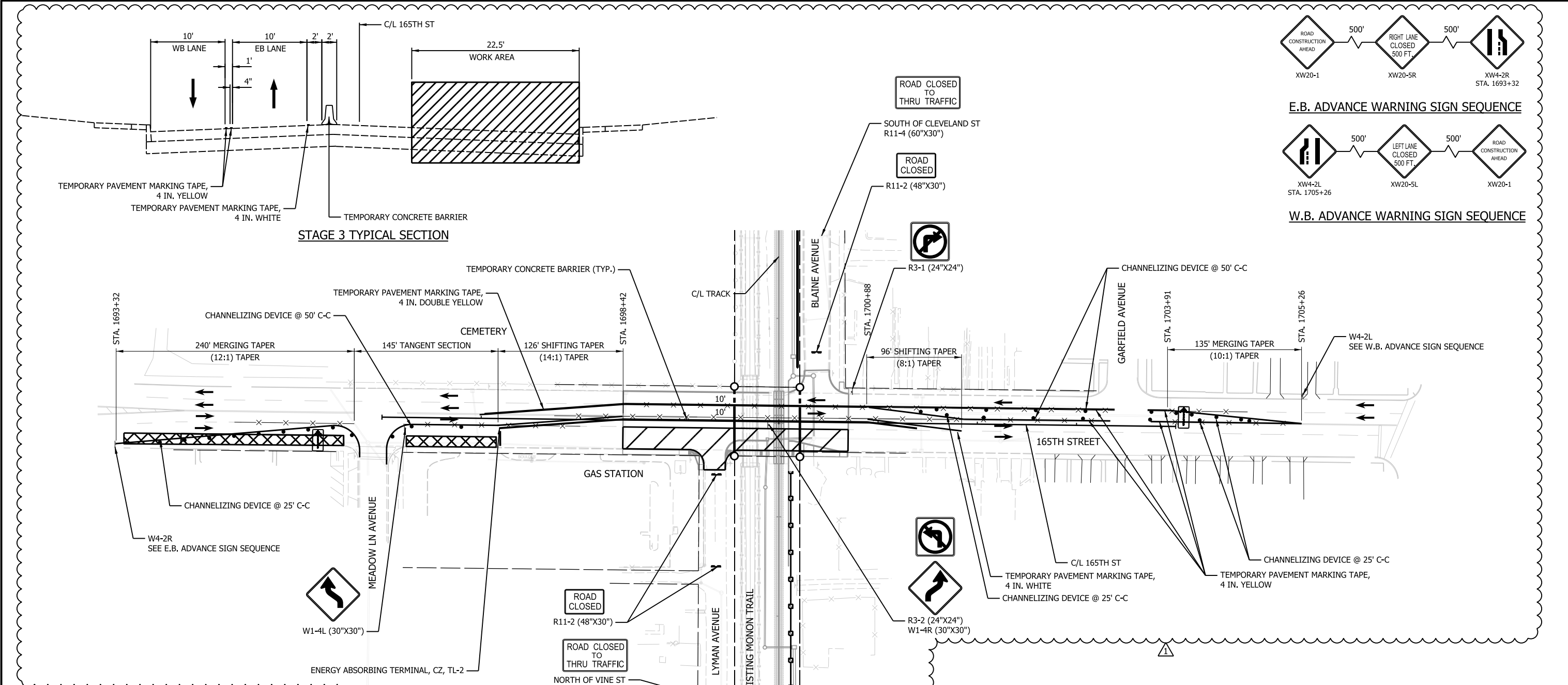

E.B. ADVANCE WARNING SIGN SEQUENCE

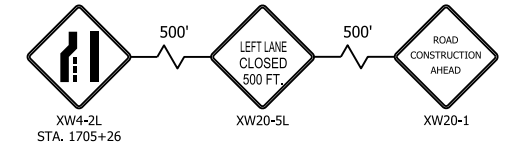

W.B. ADVANCE WARNING SIGN SEQUENCE

LEGEND

- CHANNELIZING DEVICE
- ⬇️ FLASHING ARROW SIGN
- TEMPORARY PAVEMENT MARKING
- x— REMOVAL OF PAVEMENT MARKINGS AND PRISMATIC REFLECTORS
- TYPICAL SIGN STANDARD (ROAD CLOSURE SIGN ASSEMBLY)
- TYPE III BARRICADE
- ➔ TRAFFIC FLOW
- ▨ WORK AREA
- ▩ PARKING LANE CLOSURE

- MAINTENANCE OF TRAFFIC NOTES**
- STAGE 3**
1. ESTABLISH AND MAINTAIN A DETOUR ROUTE FOR THE CLOSURE OF LYMAN AVENUE FROM NORTH OF VINE STREET TO 165TH STREET
 2. ESTABLISH AND MAINTAIN A DETOUR ROUTE FOR THE CLOSURE OF BLAINE AVENUE FROM CLEVELAND STREET TO 165TH STREET
 3. STAGE WILL CONSIST OF RECONSTRUCTION OF THE EASTBOUND LANES OF 165TH STREET FOR THE LENGTH OF ROADWAY LIMITS
 4. MAINTAIN ONE 10' LANE OF TRAFFIC IN EACH DIRECTION UTILIZING COMPLETED WESTBOUND PAVEMENT
 5. MAINTAIN POSTED 25 MPH SPEED LIMIT ON 165TH STREET
 6. SEE STD [G-CI01-GEDT-804A](#) FOR MERGING OR SHIFTING TAPER DETAILS
 7. USE THIS MAINTENANCE OF TRAFFIC PLAN WITH IMUTCD TYPICAL APPLICATION TA-32
 8. 165TH ST AND CONKEY ST SHALL NOT BE CLOSED SIMULTANEOUSLY
 9. ELECTRONIC MESSAGE BOARDS GIVING NOTICE OF LANE CLOSURES REQUIRED TO BE PLACED TWO WEEKS IN ADVANCE OF CLOSURE

F.H. PASCHEN RAGNAR BENSON JOINT VENTURE

Jacobs

REVISIONS		
ISSUE	DATE	DESCRIPTION
1	08/19/2022	DCJ-0021 165TH ST CURB

NICD

NORTHERN INDIANA COMMUTER TRANSPORTATION DISTRICT
 33 East Highway 12
 Chesterton, Indiana 46304

WEST LAKE CORRIDOR

DYER TO HAMMOND, INDIANA

REGISTERED PROFESSIONAL ENGINEER
 KATELYN S. HACKER
 PE12200177
 INDIANA

DATE: 8/18/22

BU:	M-CI01
DESIGNED:	A. SIPKOVSKY
DRAWN:	K. GOMEZ
CHECKED:	A. SIPKOVSKY
SCALE:	1"=50'
DATE:	05/11/2022

FINAL RFC PLANS DWG. NO. **M-CI01-MTBA-03**

MAINTENANCE OF TRAFFIC 165TH STREET - STAGE 3

FOR CONSTRUCTION SHEET NO. **23 OF 205**

PLOT DATE: 11/29/2021 PLOT TIME: 1:34:01 PM
 FILE NAME: SHT-S-CI05-MTPL-01.dgn

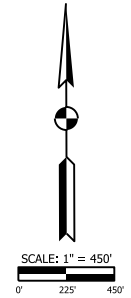
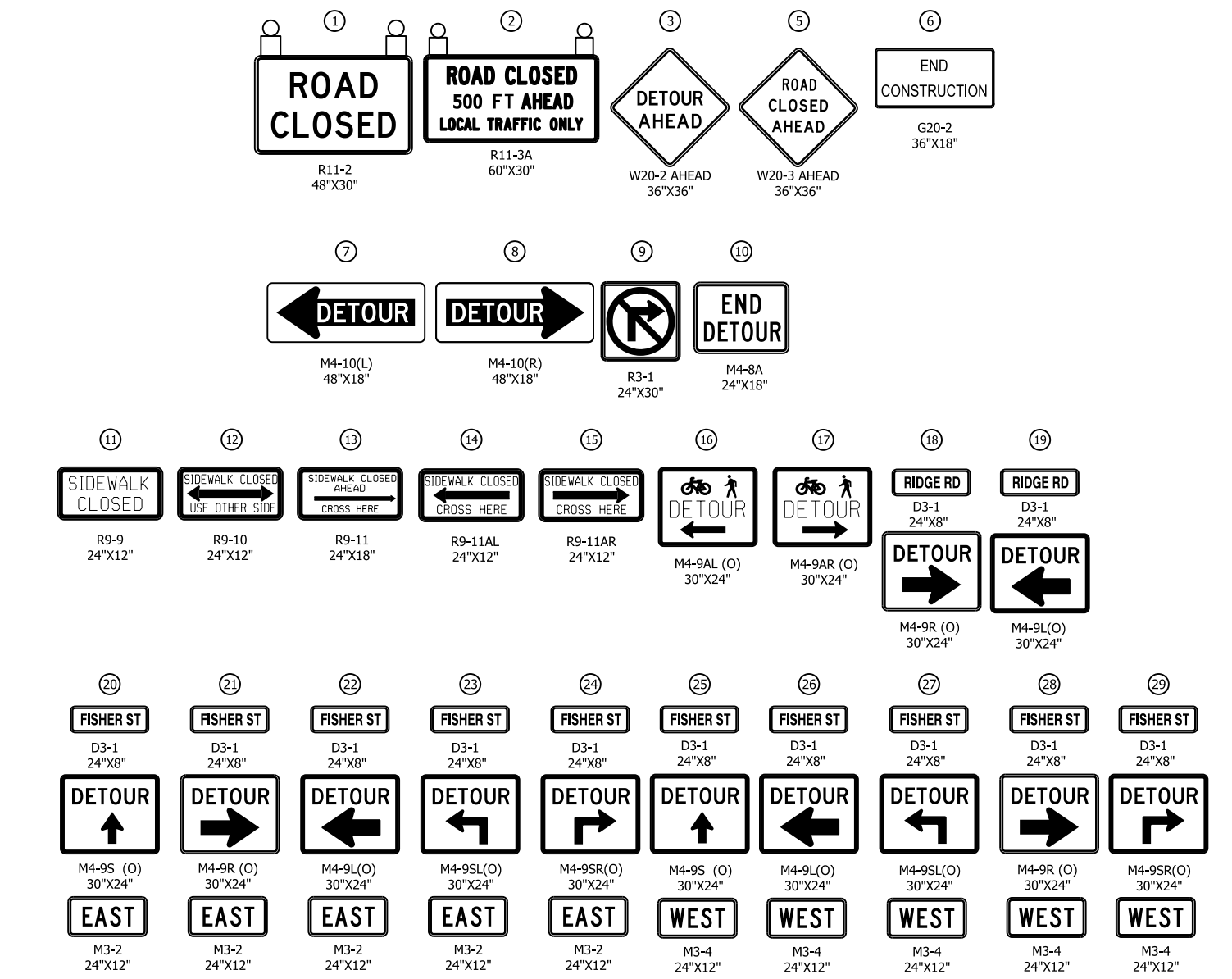
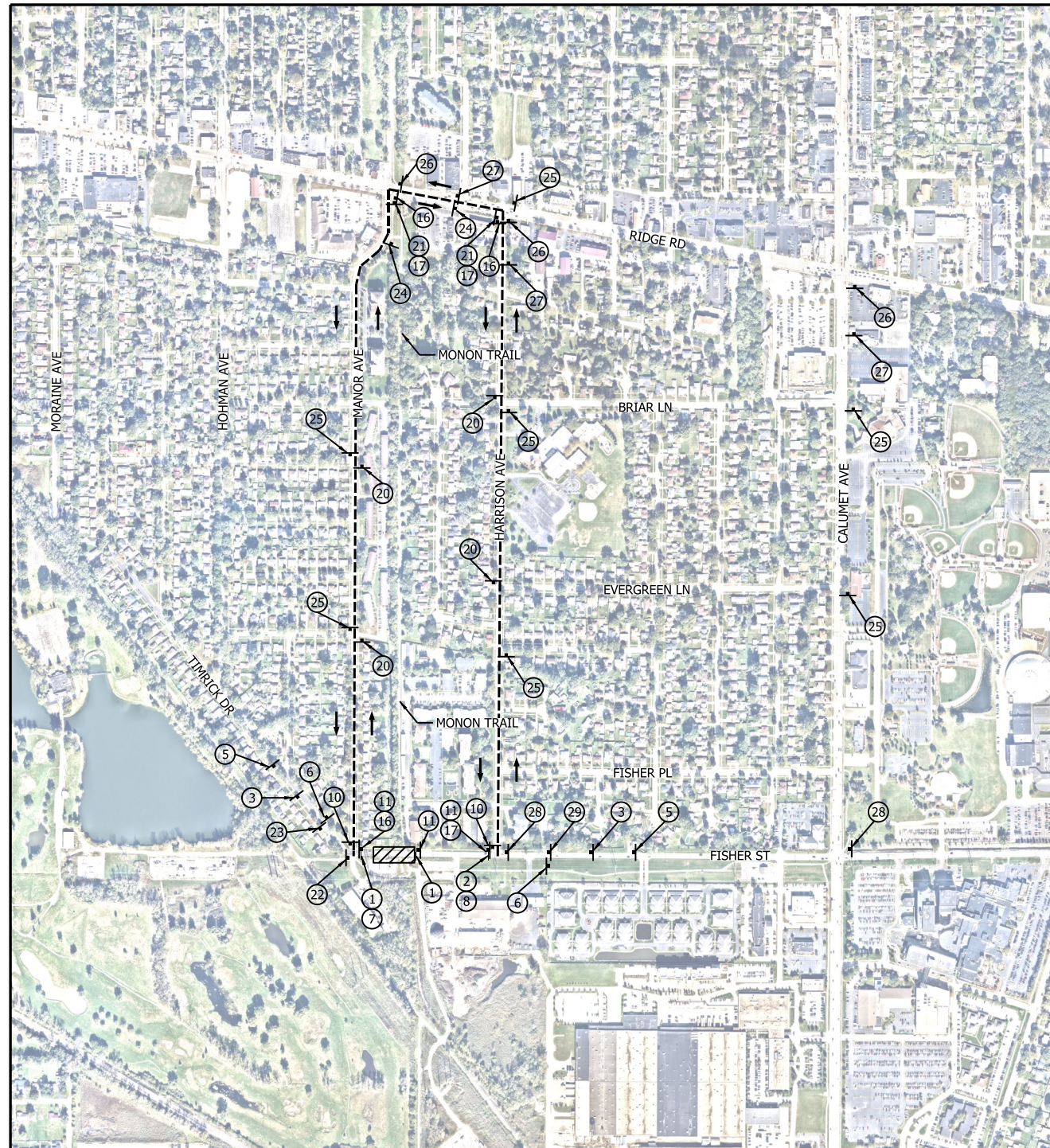

NOTES

- SIGN DESIGNATIONS ARE PER IMUTCD.
- SIGN LOCATIONS ARE APPROXIMATE. SEE BU G-C01 DWG. NO. G-CI01-GEDT-806 FOR SIGN PLACEMENT.
- SEE BU G-C01 DWG. NO. G-CI01-GEDT-824A FOR SIGN POST DETAILS.
- SEE BU G-C01 DWG. NO. G-CI01-GEDT-807 AND G-CI01-GEDT-808 FOR TYPE III BARRICADE SIGN PLACEMENT.
- CONTRACTOR TO MAINTAIN ACCESS TO NIPSCO FISHER STREET SUBSTATION DURING CLOSURE.
- RIDGE ROAD TO REMAIN OPEN DURING CLOSURE OF FISHER STREET.

LEGEND

- TYPE III BARRICADE
- + SIGN
- - - DETOUR ROUTE
- ➔ DIRECTION OF TRAFFIC
- ▨ WORK SPACE
- (O) ORANGE
- Ⓛ TYPE B LIGHT

FHP F.H. PASCHEN RAGNAR BENSON JOINT VENTURE

Jacobs

REVISIONS		
ISSUE	DATE	DESCRIPTION

NIPSCO
 NORTHERN INDIANA COMMUTER TRANSPORTATION DISTRICT
 33 East Highway 12
 Chesterton, Indiana 46304

WEST LAKE CORRIDOR
 DYER TO HAMMOND, INDIANA

PROFESSIONAL ENGINEER
 PE12100055
 DATE: 11/30/21

BU:	S-CI05
DESIGNED:	A. SIPKOVSKY
DRAWN:	S. KOZLOWSKI
CHECKED:	A. SIPKOVSKY
SCALE:	1"=450'
DATE:	12/1/2021

FINAL RFC PLANS DWG. NO. S-CI05-MTPL-01

**MAINTENANCE OF TRAFFIC
 DETOUR PLAN - FISHER STREET**

FOR CONSTRUCTION SHEET NO. 12 OF 87

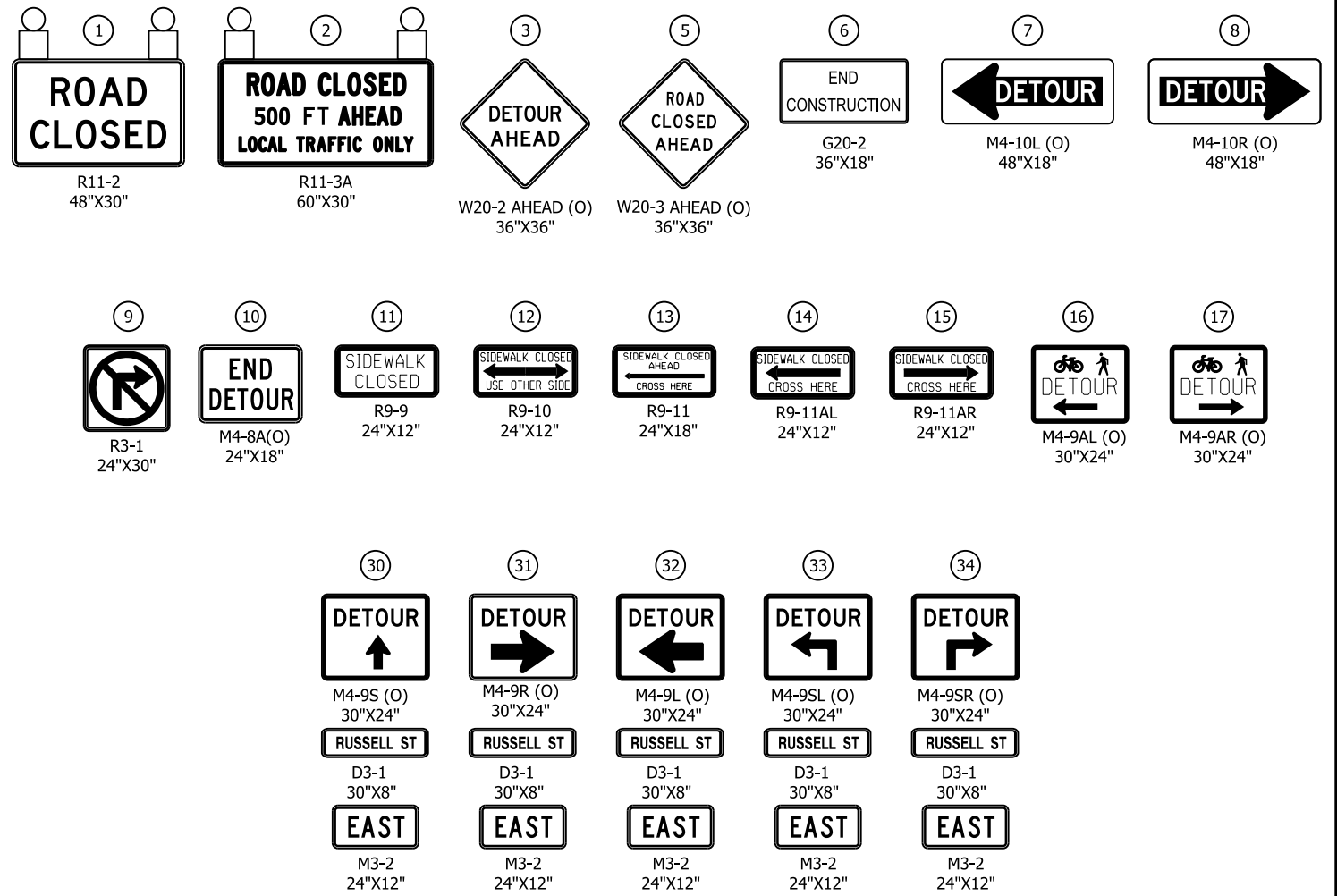
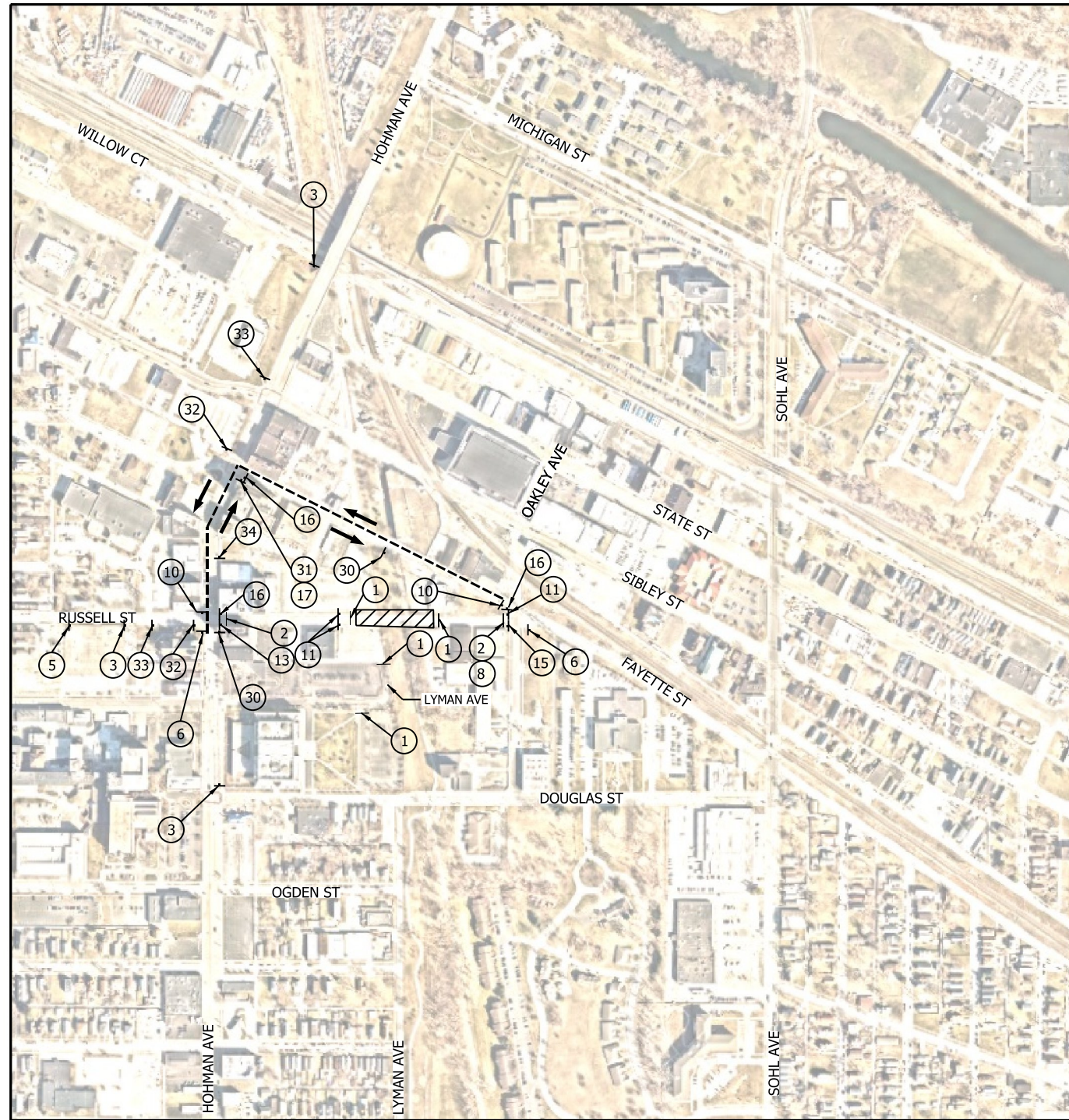

NOTES

- SIGN DESIGNATIONS ARE PER IMUTCD.
- SIGN LOCATIONS ARE APPROXIMATE. SEE BU G-C01 DWG NO. [G-CI01-GEDT-801](#), [G-CI01-GEDT-802](#), AND [G-CI01-GEDT-803](#) FOR SIGN PLACEMENT.
- SEE BU G-C01 DWG NO. [G-CI01-GEDT-820](#), [G-CI01-GEDT-821](#) AND [G-CI01-GEDT-822](#) FOR SIGN POST DETAILS.
- SEE BU G-C01 DWG NO. [G-CI01-GEDT-807](#) AND [G-CI01-GEDT-808](#) FOR TYPE III BARRICADE APPLICATION STANDARDS.
- THE CONTRACTOR SHALL MAINTAIN FREE PASSAGE OF PEDESTRIANS ON ONE SIDE OF RUSSELL STREET WHEN PRACTICABLE.
- RUSSELL STREET IS CURRENTLY A ONE-WAY STREET EASTBOUND. PRIOR TO ANY WORK SPACE CLOSURES ON RUSSELL STREET, CONVERT TO TWO-WAY AND PLACE THE PROPOSED SIGNS AS SHOWN ON THE 'SIGNING AND PAVEMENT MARKING' PLAN FOR RUSSELL STREET ON [DWG NOS. N-CI05-RDSN-02](#), [N-CI05-RDSN-03](#), [N-CI05-RDSN-04](#).
- LYMAN AVENUE IS THE ONLY OUTLET FROM THE FEDERAL PLAZA PARKING LOT. SEE DWG NOS. [N-CI05-MTPL-07](#) AND [N-CI05-MTPL-08](#) FOR LOT DETOUR INFORMATION.

LEGEND

- TYPE III BARRICADE
- SIGN
- - - - DETOUR ROUTE
- DIRECTION OF TRAFFIC
- ▨ WORK SPACE
- (O) ORANGE
- TYPE B LIGHT

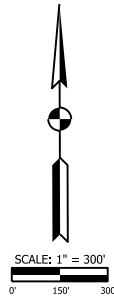

PLOT DATE: 4/25/2022 PLOT TIME: 10:29:00 AM
FILE NAME: SHT-N-CI05-MTPL-02.dgn



REVISIONS		
ISSUE	DATE	DESCRIPTION



BU:	N-CI05
DESIGNED:	A. SIPKOVSKY
DRAWN:	S. KOZLOWSKI
CHECKED:	A. SIPKOVSKY
SCALE:	1"=300'
DATE:	05/03/2022

FINAL RFC PLANS DWG NO. N-CI05-MTPL-02



**MAINTENANCE OF TRAFFIC
DETOUR PLAN - RUSSELL STREET**

FOR CONSTRUCTION SHEET NO. 10 OF 62

Waltham Street Detour Plan

Eastbound Detour Waltham Street Detour

Legend

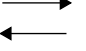
- Vehicle Detour 
- Work Zone 
- Type III Barricade 
- Traffic Pattern 
- 2-Way traffic between Blaine Ave and Harrison Ave during construction only

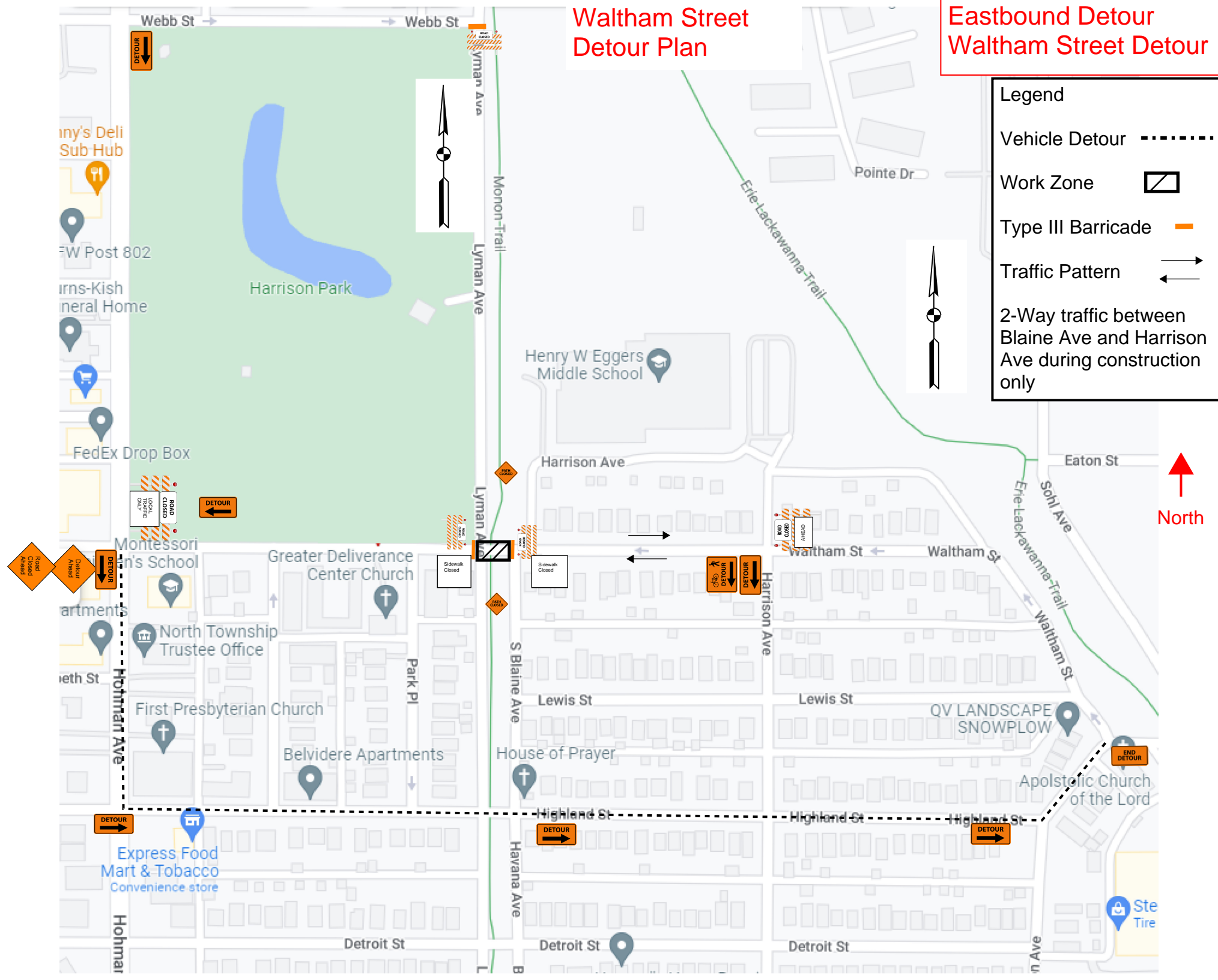

Waltham Street Detour Plan

Northbound Detour Lyman Ave.

Legend

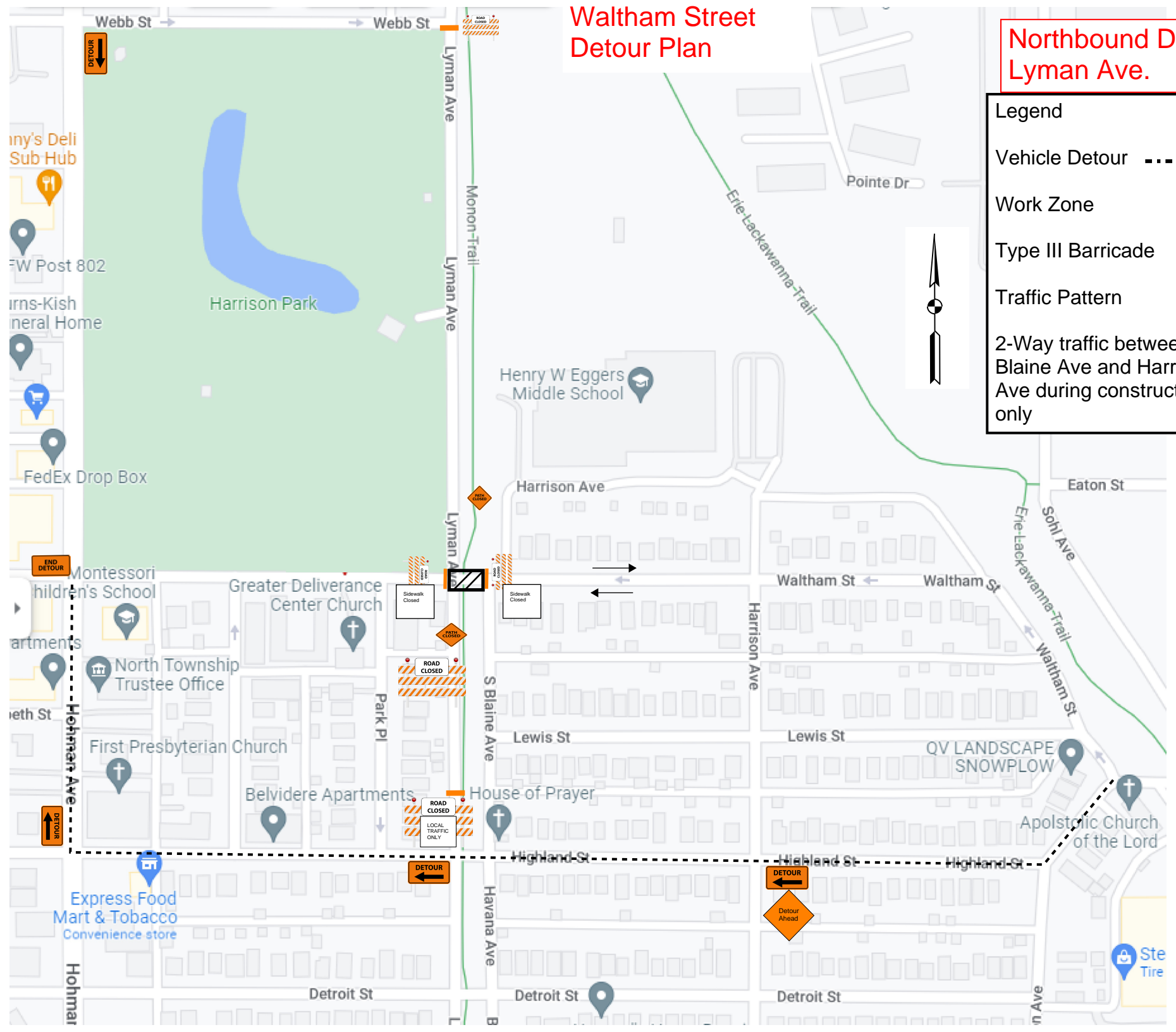

- Vehicle Detour (dashed line)
- Work Zone [diagonal hatched box]
- Type III Barricade [orange bar]
- Traffic Pattern [right arrow] [left arrow]
- 2-Way traffic between Blaine Ave and Harrison Ave during construction only [double-headed arrow]



Waltham Street Detour Plan

Southbound Detour Lyman Ave

Legend

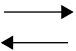
- Vehicle Detour 
- Work Zone 
- Type III Barricade 
- Traffic Pattern 
- 2-Way traffic between Blaine Ave and Harrison Ave during construction only

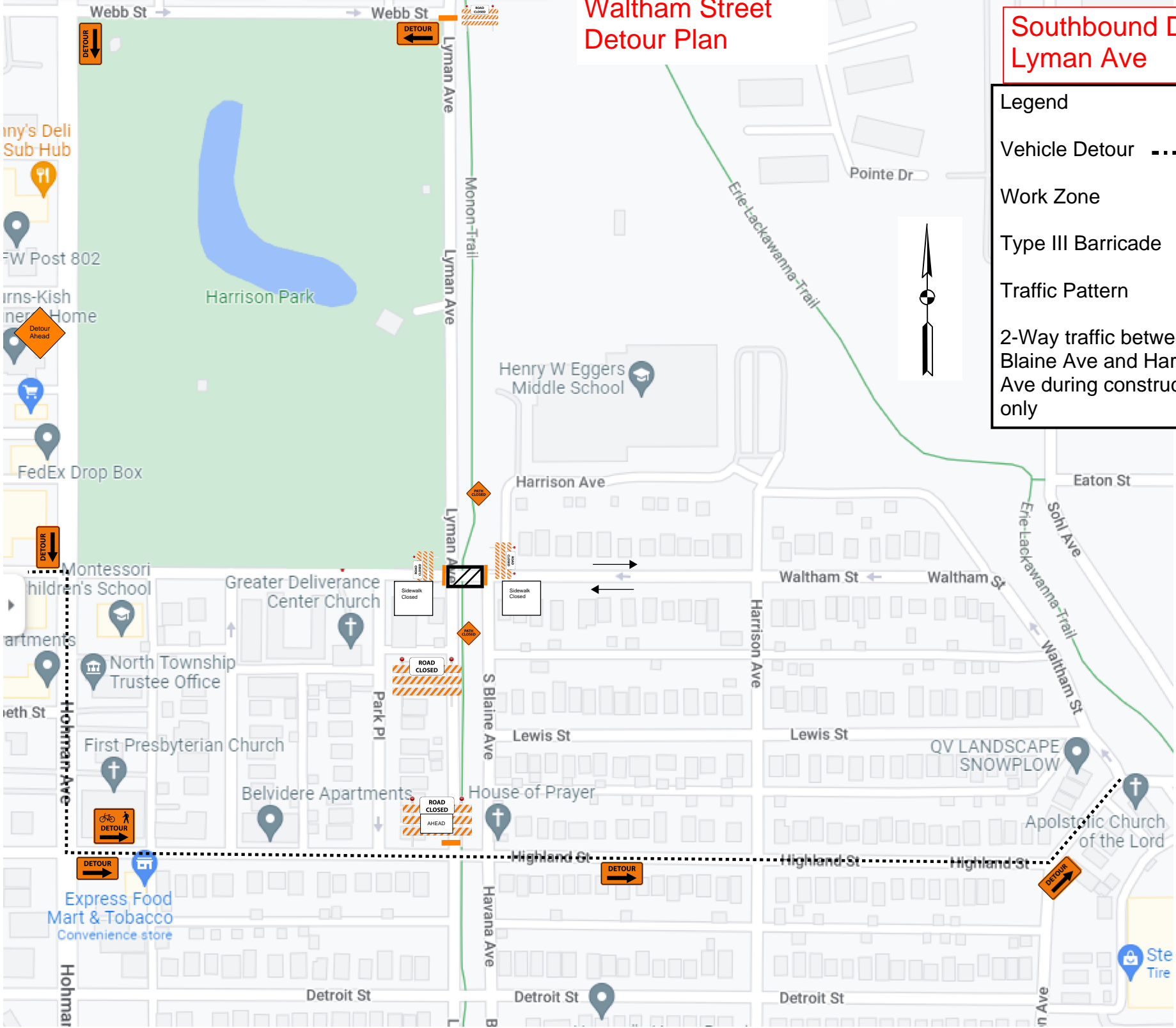

Waltham Street Detour Plan

Westbound Detour Waltham Street

Legend

- Vehicle Detour (dashed line)
- Work Zone [diagonal hatched box]
- Type III Barricade [orange bar]
- Traffic Pattern [arrows]
- 2-Way traffic between Blaine Ave and Harrison Ave during construction only

